



# WESTLAND SHOPPING CENTER

2500-2560 Williams Boulevard, Kenner, LA 70062

## CENTER PROFILE

Total Square Feet	109,110
Number of Stores/Services	16
Number of Levels	1
Number of Parking Spaces	513

## MAJOR TENANTS

Herzing University	17,437 SF
Houston Marine	15,051 SF
It's Fashion Metro	10,125 SF

## MARKET DEMOGRAPHICS

<b>1 Mile</b>		
Population		13,318
Number of Households		5,013
Average Household Income		\$53,160

<b>3 Mile</b>		
Population		117,601
Number of Households		46,654
Average Household Income		\$68,219

<b>5 Mile</b>		
Population		193,222
Number of Households		80,091
Average Household Income		\$70,055

## LOCATION



# WESTLAND SHOPPING CENTER

## Tenant List by Category

<b>FOOTWEAR</b>	
Shoe Show	2522
<b>SPECIALTY SHOPS</b>	
Perret's Army Surplus	2514
<b>GENERAL MERCHANDISE AND VARIETY</b>	
Family Dollar	2530
<b>RESTAURANT/FOOD</b>	
X-Treme Burgers & Shakes	2560
<b>FINANCIAL</b>	
Capital One Bank	OP
<b>SERVICES</b>	
CADA Insurance	2548
Claude's Barber Shop	2538
Delta World Tire	2554
East Jefferson Medical Clinic	2552
H&R Block	2544C
Just Kids Dental	2526
Top Line Nails	2544B
<b>OFFICE</b>	
Morguard Management Company	2542
<b>MAJOR TENANTS</b>	
Herzing University	2500A
Houston Marine	2506
It's Fashion Metro	2518A

## LEASING INQUIRIES

Marc Dusang  
 2542 Williams Boulevard, Kenner, LA 70062  
 Phone 504-904-8515 Fax 504-904-8501  
 mdusang@morguard.com  
 morguard.com



# WESTLAND SHOPPING CENTER

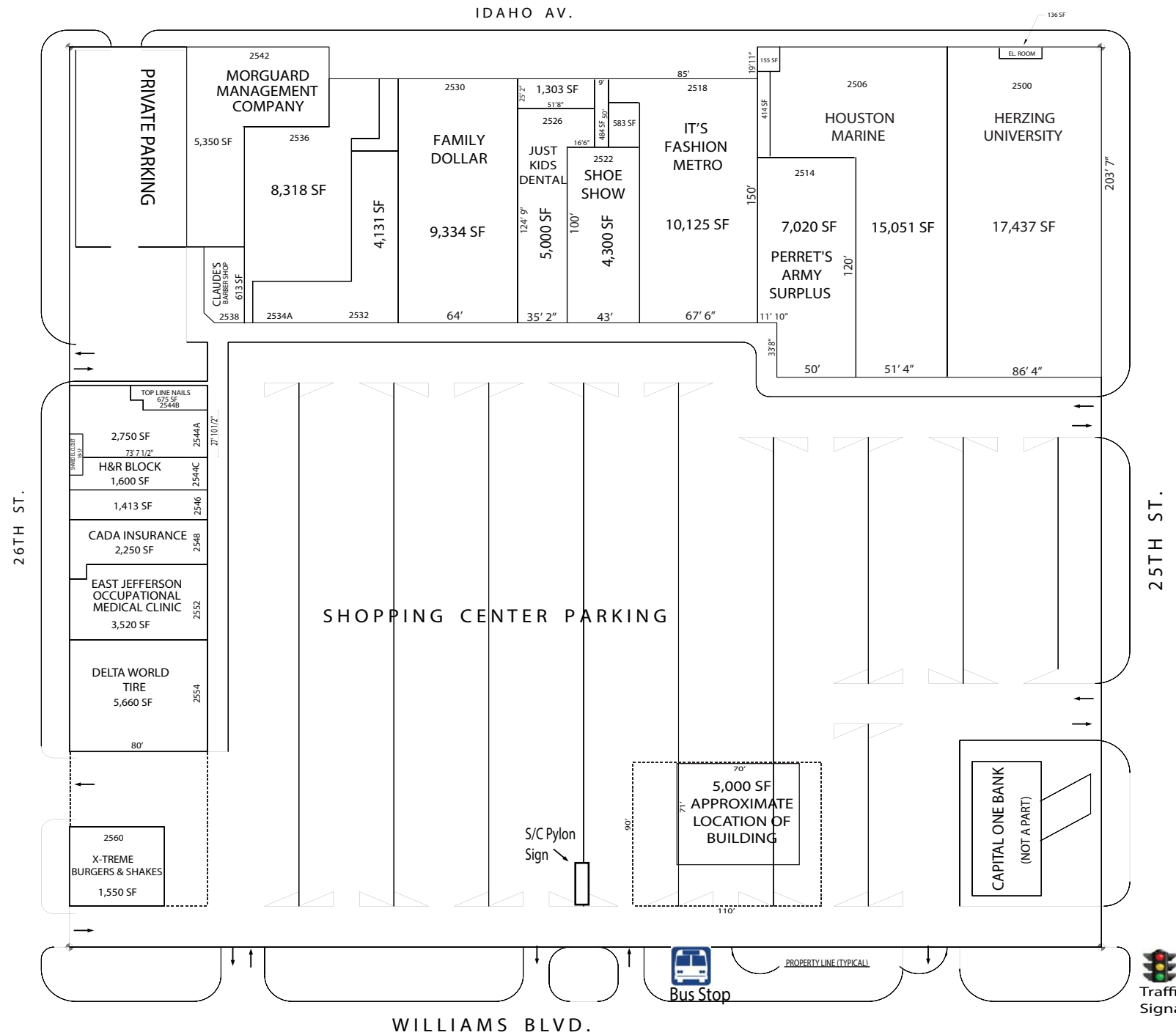

## Lease Plan

SCALE: N.T.S.

All dimensions subject to field verification

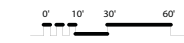

Permissible Building Areas

This exhibit shall not be deemed to be a warranty, representation or agreement on the part of the Landlord that the shopping center will or continue to be as indicated hereon without change, and Landlord may, from time to time and in any manner whatsoever, increase, reduce or change the parking areas or common areas as Landlord shall deem proper, and Landlord reserves the right to change the general layout and to make alterations or additions to, and to build additional stories on the buildings in which the leased premises are contained, and to add buildings adjoining same or elsewhere in the shopping center, and any other changes as may be required by governing authorities. The plan is subject to change, and is neither a warranty, representation nor agreement that prospective tenants and department stores shown here will be tenants or department stores at the location shown or at any other location at this shopping center. All measurements must be field verified.