

FAX (318) 322-7168

REVISIONS - DATE

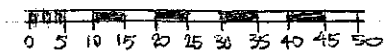
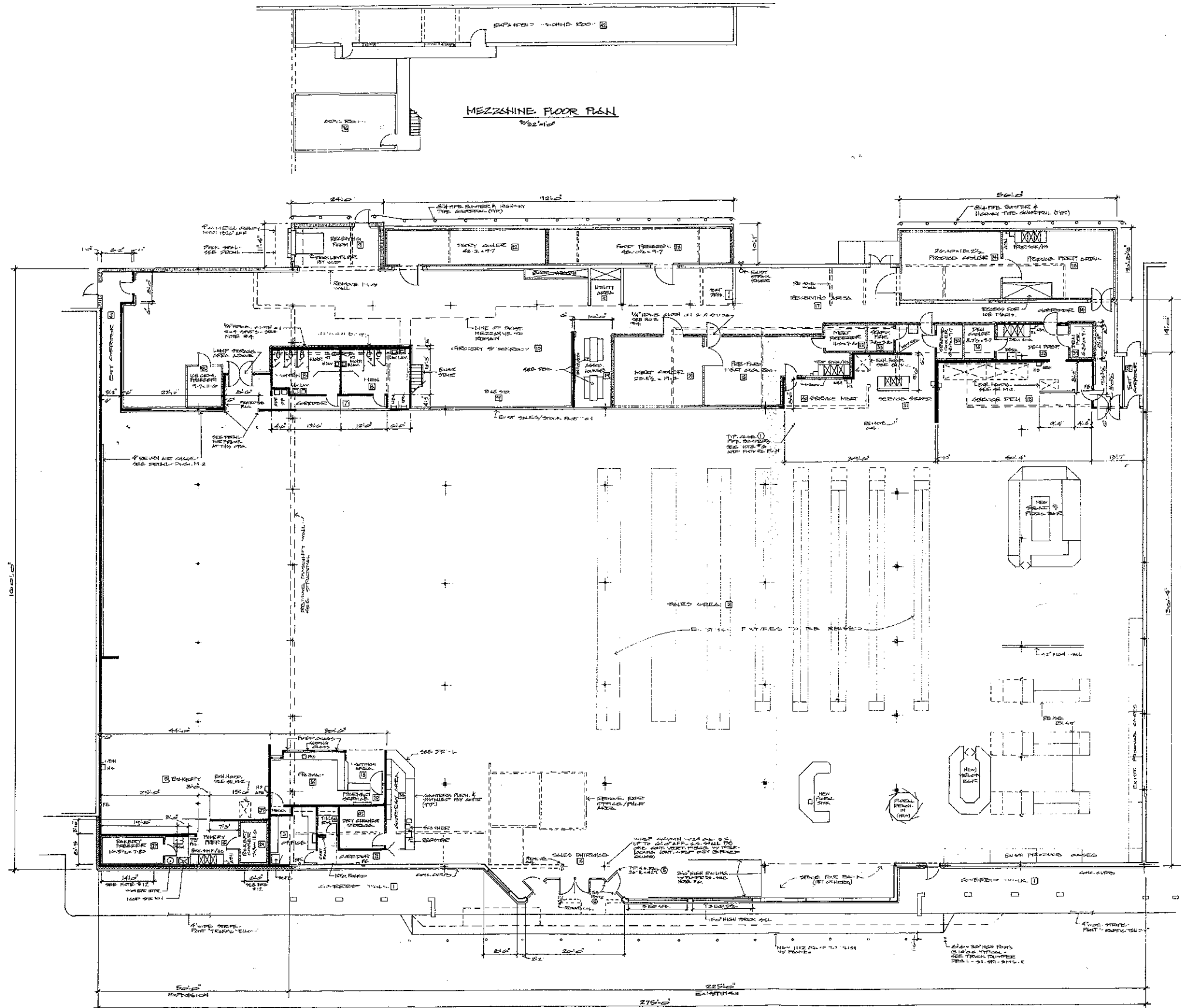

FLOOR PLAN
312' x 112'

GENERAL NOTES

- 1) FE INDICATES FIRE EXTINGUISHERS - 10 LB. ABC DRY CHEMICAL FURNISHED & INSTALLED BY CONTRACTOR. PROVIDE A 12" x 36" AREA ON WALL PAINTED RED. MOUNT FE IN BACKROOM AREAS. PROVIDE 1 FE CABINET (SEE SPECIFICATIONS IN SALES AREA). TOP OF FE MOUNTED @ 4'-3" AFF. NOTE: SPE IN THE OFFICE INDICATES A SPECIAL FIRE EXTINGUISHER ABC TYPE.
- 2) DO NOT CONSTRUCT A SECTION OF THE OFFICE WALLS UNTIL SAFE HAS BEEN INSTALLED.
- 3) THE REAR SALES AREA WALL SEPARATING THE SALES AREA FROM THE BACKROOM SHALL BE 2x4 STUDS @ 24" OC WITH PANELING & 5/8" GYPSUM BOARD ON THE SALES AREA SIDE AND 5/8" FIRECODE GYPSUM BOARD FROM FLOOR TO ROOFJOIST ON BACKROOM SIDE. APPLY 1/2" EXTERIOR GRADE PLYWOOD WANSKOT 8'-0" HIGH TO GYPSUM BOARD ON BACKROOM SIDE. WANSKOT TO CONTINUE BEHIND COOLERS & FREEZERS & 5/8" GYPSUM BOARD TO CURT OVER MEAT WALL.
- 4) PROVIDE 1/4" MESH GALVANIZED HARDWARE CLOTH ON INSIDE OF 2x4 STUDS @ 24" OC FROM TOP OF FREEZER, COOLER, TOILET AREA & MEAT CUTTING ROOM TO BOTTOM OF ROOF DECK.
- 5) REFRIGERATION TUBING TRENCH SHALL BE ENCLOSED WITH 2x4 STUDS & COVERED WITH 1/2" INTERIOR GRADE PLYWOOD FROM FLOOR TO CEILING.
- 6) PROVIDE A MINIMUM OF 2 1/2" x 14 GAUGE PIPE BUMPER WITH 1 5/8" x 14 GAUGE CROSS RAILING. PIPE BUMBERS TO HAVE CAPS & FLOOR ESCUTCHEON RING. INSTALL PIPE BUMPER AFTER CASES HAVE BEEN SET-IN-PLACE. BUMBERS SHALL FINISH 36" AFF WITH A MINIMUM OF 3" RECESSED IN FLOOR SLAB. DRILL FLOOR WITH CORE BORE MACHINE. SET BUMBERS & FILL WITH NON-SHRINK GROUT. ALL INSIDE PIPE BUMBERS & RAILINGS TO BE CHROME PLATED OR STAINLESS STEEL UNLESS OTHERWISE NOTED. ALL OUTSIDE PIPE BUMBERS & RAILINGS TO BE PAINTED STEEL. SEE SCHEDULE THIS DRAWING.
- 7) ALL TRENCHES AND PULLBOXES SHALL HAVE SEALED CONCRETE BOTTOMS & SIDES TO FINISH FLOOR.
- 8) ALL EXTERIOR OPENINGS, ROOMS, CHASE & ATTIC SHALL BE "RODENT PROOF".
- 9) COLUMNS TO BE INCLUDED ON EXPANSION SIDE WALL.
- 10) CONTRACTOR MAY USE METAL STUDS IN LIEU OF WOOD STUDS (WHERE POSSIBLE). USE 18 GAUGE STUDS FOR PARTITION WALLS & 25 GAUGE STUDS FOR CURTAIN WALLS.
- 11) ASH INDICATES ANTISEPTIC BOWL HOLDER AS MFG BY LOAD KING. MODEL NO. ABM-131510.
- 12) CONIC CURBS IN BACKROOM AREAS TO BE INSTALLED AFTER WALLS, COOLERS AND FREEZERS HAVE BEEN ERECTED.
- 13) CONTRACTOR TO INSTALL 1"x4" ON TOP OF CASE AT AIR CHASE. SEE DETAIL ON DWG M-2.
- 14) COLUMNS IN 2x6 WALL MUST NOT PROJECT BEYOND FACE OF STUDS ON SALES AREA SIDE.
- 15) PROVIDE TRASH RECEPTORS (SOBRICK NO.2250) AT EACH LAVATORY & HAND SINK.
- 16) ALL STUD WALLS TO BE 2"x6" UNLESS OTHERWISE NOTED.
- 17) STOP CERAMIC TILE BEHIND COOLERS AND FREEZERS AT 1-85 POINT. CONTINUE 1/2" SHEETROCK W/ TAPED JOINTS ON STUD WALLS BEHIND COOLERS AND FREEZERS.
- 18) ALTERATIONS TO EXISTING WORK BEING OF SUCH NATURE THAT FINISHES OR WORK ARE IMPOSSIBLE TO DETAIL AND SPECIFY IT IS THEREFORE THE RESPONSIBILITY OF THE CONTRACTOR TO CAREFULLY EXAMINE THE DRAWING AND FURNISH HIS OWN MEASUREMENTS AND REVISIONS. THESE CORRECTIONS WILL BE MADE AT HIS OWNERS RISK.
- 19) ALL EXISTING TRENCHES, DITCHES AND ALL EXISTING SINKS AND TOILETS TO BE REMOVED. SHALL BE REMOVED IMMEDIATELY UPON START OF WORK.
- 20) PROVIDE PROTECTIVE AND SAFETY NETS TO BE USED TO PROTECT ALL EXISTING WORK AND STRUCTURE.
- 21) THERE IS STRUCTURAL ASPECTS TO SAFETY NETS TO BE USED.
- 22) ALL CONTRACTORS SHALL MAINTAIN SAFE AS DIRECTED BY THE OWNER.
- 23) ALL COOLERS, FREEZERS, AND PREPARED CUTTING ROOMS TO BE 5'-0" HIGH SHEET & INSTALLED BY THE CONTRACTOR.

IT IS RECOMMENDED THAT THE SUB-CONTRACTOR ARRANGE & PREPARE CONTRACT DOCUMENTS FOR REVIEW AND CERTIFICATION BEFORE STARTING ANY WORK.
CALL: MS. LEGAY, (504) 231-1322

CONTRACTOR SHALL VERIFY ALL FINISH AND REQUIREMENTS WITH TENANT.



PAUL F. STEWART ARCHITECT LTD.
ROBERT P. HOLTZCLAN - PROJECT ARCHITECT
1004 STUBBS AVE.
MONROE, LA 70001



ALTERATIONS AND ADDITIONS
WINN DIXIE #1416
LAPALCO VILLAGE SHOPPING CENTER
LAPALCO & AMES BLVD. - MONROE, LA

ACTIVE FILE	INACTIVE FILE
A2	A14
OF	

DATE 12-1-94

PROJECT NUMBER 94-152

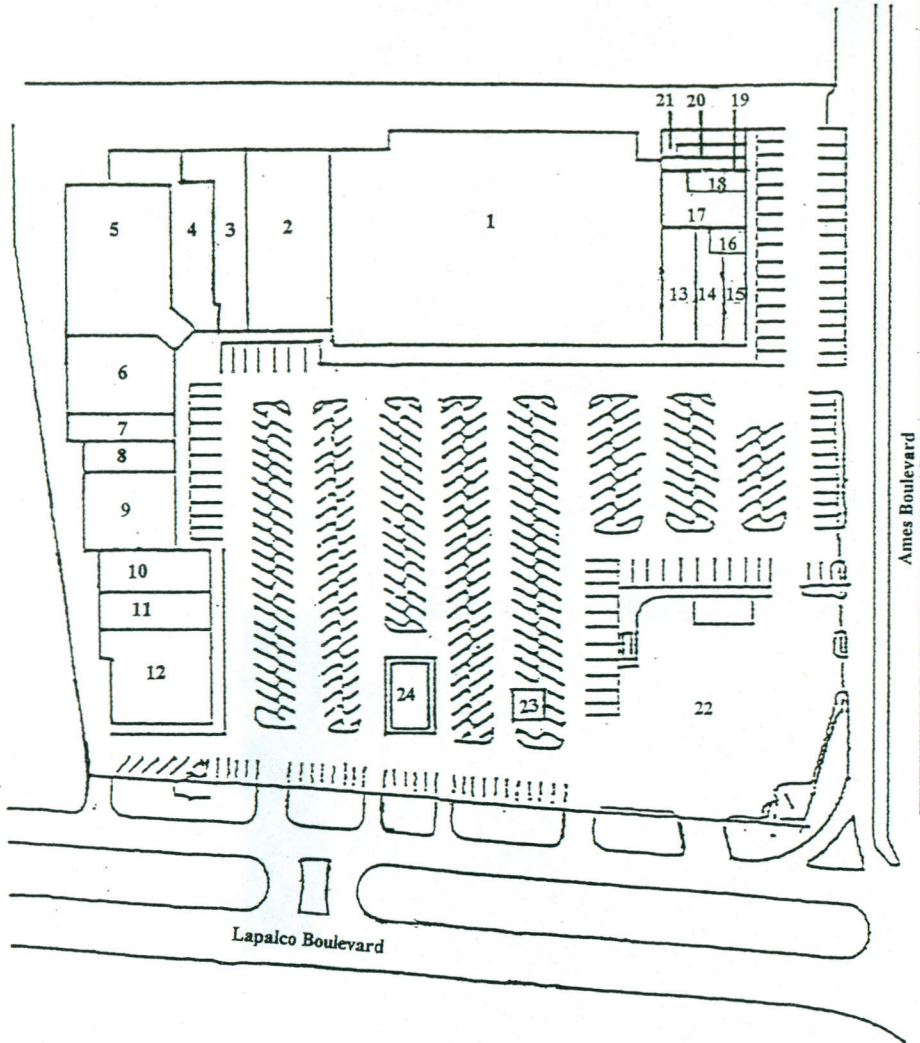

LAPALCO VILLAGE SHOPPING CENTER

Marrero, Louisiana

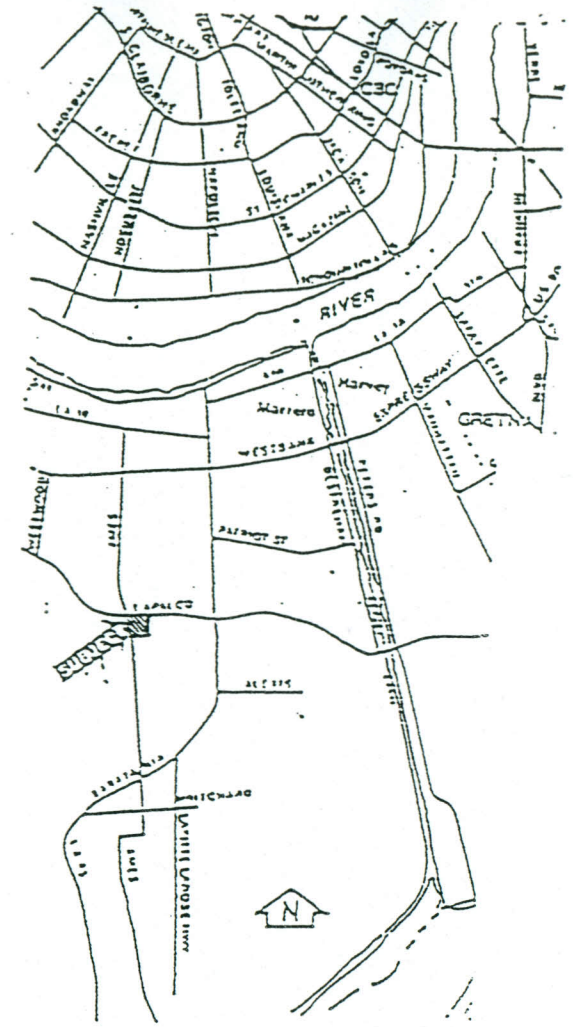

LEGEND

- (5969) 1 Winn-Dixie
- (5949) 2 Family Dollar
- (5943) 3 Reflections Urban Ware
- (5941) 4 Suit Warehouse
- (5939) 5 Hi-Sytle
- (5929) 6 Rent Smart
- (5927) 7 Envy
- (5925) 8 Glamour Fashions
- (5923) 9 Soul Train Fashions
- (5917) 10 Beauty Outlet
- (5915) 11 Money to Lend
- (5901) 12 Cash America
- (5983) 13 World Communications
- (5985) 14 Beverly Hills Hair & Nails
- (5987) 15 Mo Money - Marrero
- (5989) 16 Cachet Wigs
- (5991) 17 Vacant
- (5993) 18 Fast Tax
- (5993A) 19 His 'N Hers
- (5995) 20 Liberty Faith Church
- (5999) 21 Liberty Faith Church
- (5997) 22 Shell Oil
- 5995A 23 Watermill Express
- (5957) 24 Joe's Cafe

Rev. 1/1/10