

Making Connections: People. Places. Environment.

TEAM D

The design establishes new connections along 2½ miles of unused and unattractive space bordering West Esplanade Drainage Canal, between Causeway Boulevard and Lake Avenue. Establishing a linear parkway, three key areas for development, as well as creating a tree-lined boulevard will, over time, transform the corridor's aesthetic. Placement of willow oaks and native iris at strategic locations, will screen unsightly utility pipes from pedestrians, bicyclists travelling within the parkway, and the 28,000 average daily vehicles travelling along West Esplanade. The design impact increases recreational opportunities, usability of valuable open space, and encourages short-term and long-term investment into the community.

Located along the Mississippi Flyway, the canal is home to both resident and migratory bird populations. Several bird species were observed during team investigations including: blue heron, brown pelican, egrets, and Muscovy ducks. Providing habitat for these birds integrates visual screening of unsightly utility pipes in a way that does not compromise flood control.

Creating pedestrian and bicycle friendly spaces within the drainage canal right-of-way will provide opportunities for neighbors to interact. Canal Square will serve as a key entry point into the parkway at Causeway Boulevard. The proposed design recommends new commercial space facing the canal, offers public access to the water, and 7,500 square feet of additional public plaza space. Landscape improvements, two decks spanning the canal, and concrete seatwalls create an aesthetically pleasing view of the canal to those traveling along Causeway Boulevard, and drawing visitors to explore the parkway.

The flexible design of Hesper Plaza accommodates larger community gatherings and day-to-day usage. The proposed pavilion and 31,000 square feet of existing open space can be used for cultural events, recreational, and leisure activities. Designed to serve the surrounding neighborhoods, Lake Avenue Park, proposed an additional 12,500 square feet of green space by reducing the number of travel lanes from four to two along West Esplanade between Papworth and Lake Avenues; allowing for incorporation of on-street parking to accommodate visitors. While specific traffic data is not available block by block, direct observation suggests that traffic along West Esplanade is redirected either north or south before this section nearest the 17th Street Canal levee. Park amenities include: a basketball court, children's playground, and bark park.

Generous eight foot sidewalks separated from traffic; safe crossings and attractive landscaping improve the corridor's visual appearance, pedestrian safety, and creates a more interconnected community. Strategic screening and mitigation measures along the canal's length establish a visually appealing environment for pedestrians, bicyclists, and motorists experiencing the canal from their windshield. It is recommended that a combined strategy of increasing pedestrian safety be implemented which may consist of: flashing beacons, signalized pedestrian crossings, in-roadway warning lights, crosswalk markings, and signage.

Making Connections will generate a connective spine: linking people, places, and environments that will strengthen community pride. The proposed design solution solves typical conditions found within Jefferson Parish and has considerable potential to transform the parish appearance while providing recreational space to support a healthy and connected population.

Making Connections

people. places. environment.



CANAL SQUARE
Perspective 1

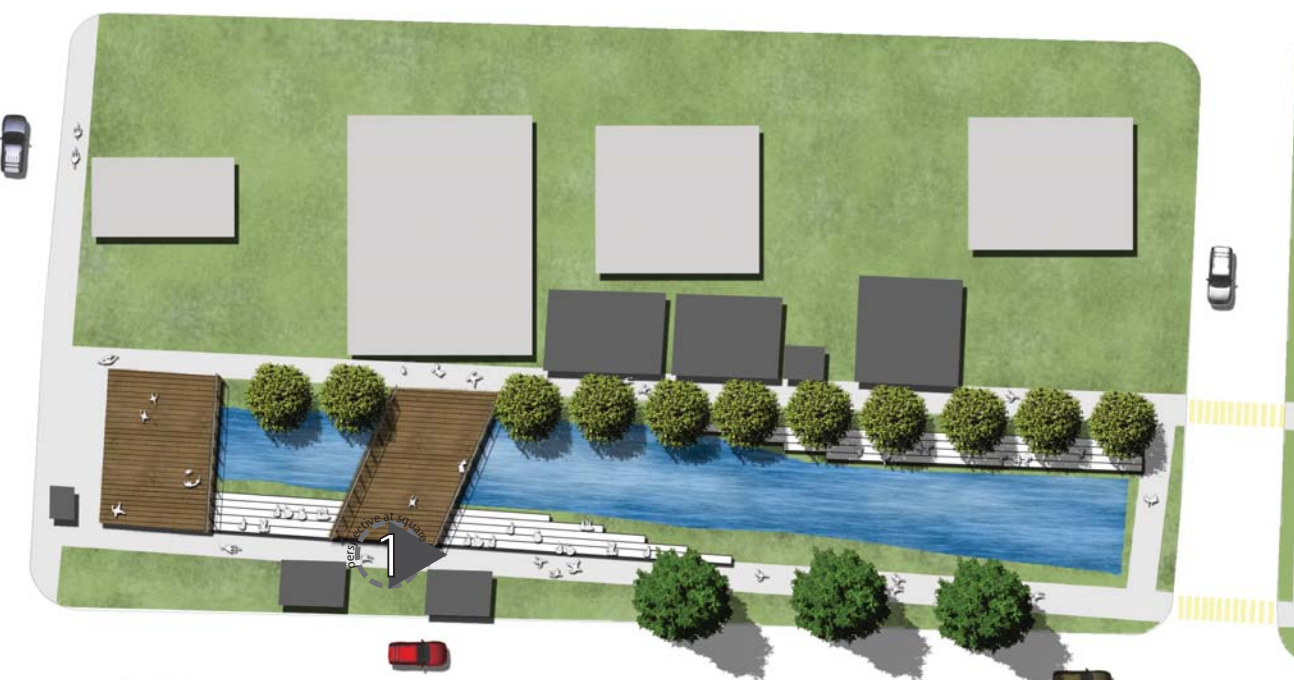

CANAL SQUARE
Plan View

Canal Square makes a public space amenity out of a previously unattractive and unused section of West Esplanade Drainage Canal. New commercial space engages the water and helps to activate this attractive space. Providing public access to the water and an additional 7,500 square feet of public plaza space will draw residents and visitors to the square and parkway beyond.

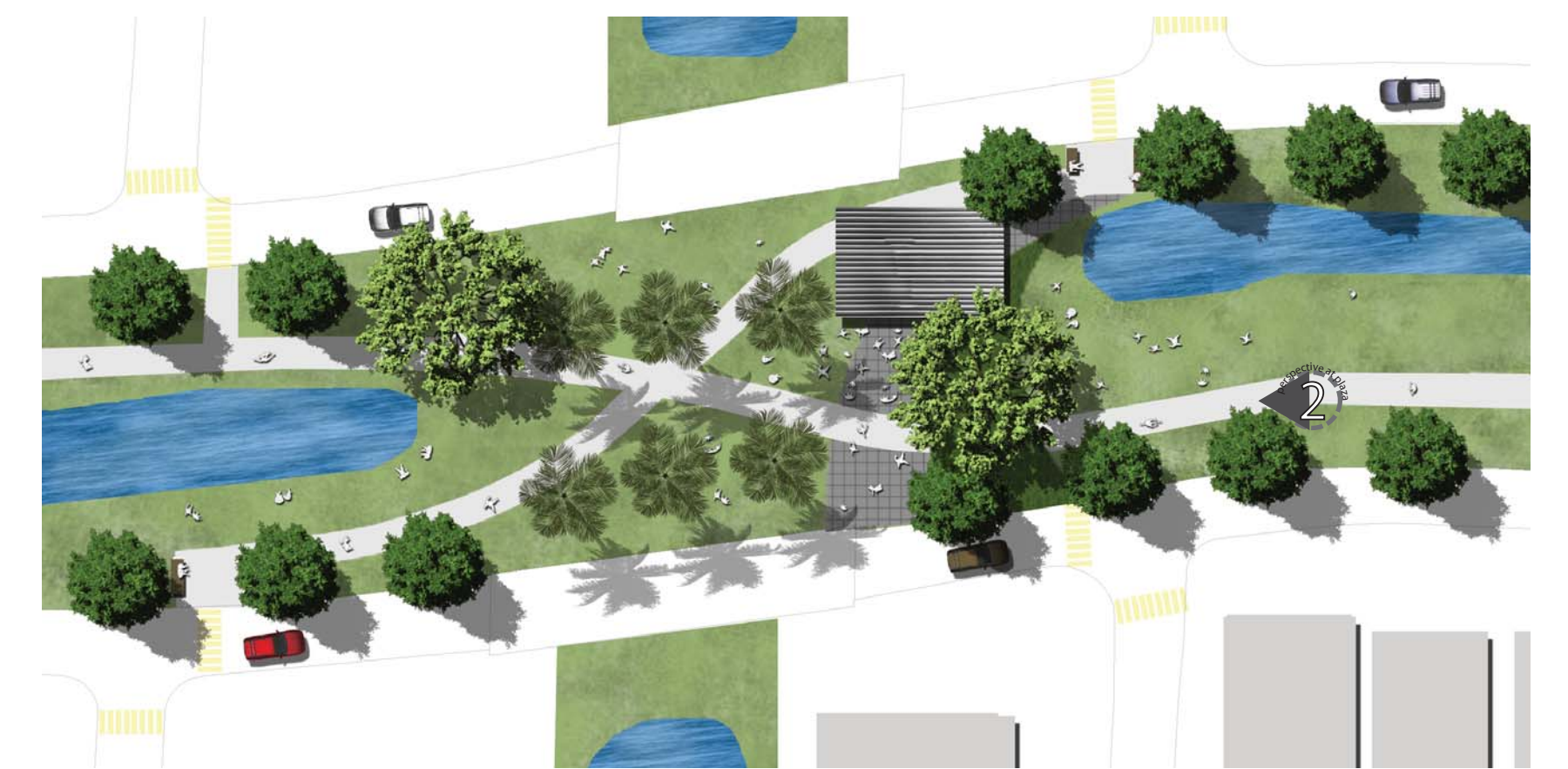

HESPER PLAZA
Plan View

Hesper Plaza takes advantage of the existing open space, which covers West Esplanade Drainage Canal where it crosses Bonabel Canal. The promenade attracts pedestrians into the space and the plaza provides a flexible area accommodating large community gatherings and day-to-day use. The new pavilion can be used by the community for cultural events, picnicking, and other recreation or leisure activities.



SITE PLAN

HESPER PLAZA
Perspective 2



LAKE AVENUE PARK
Perspective 3

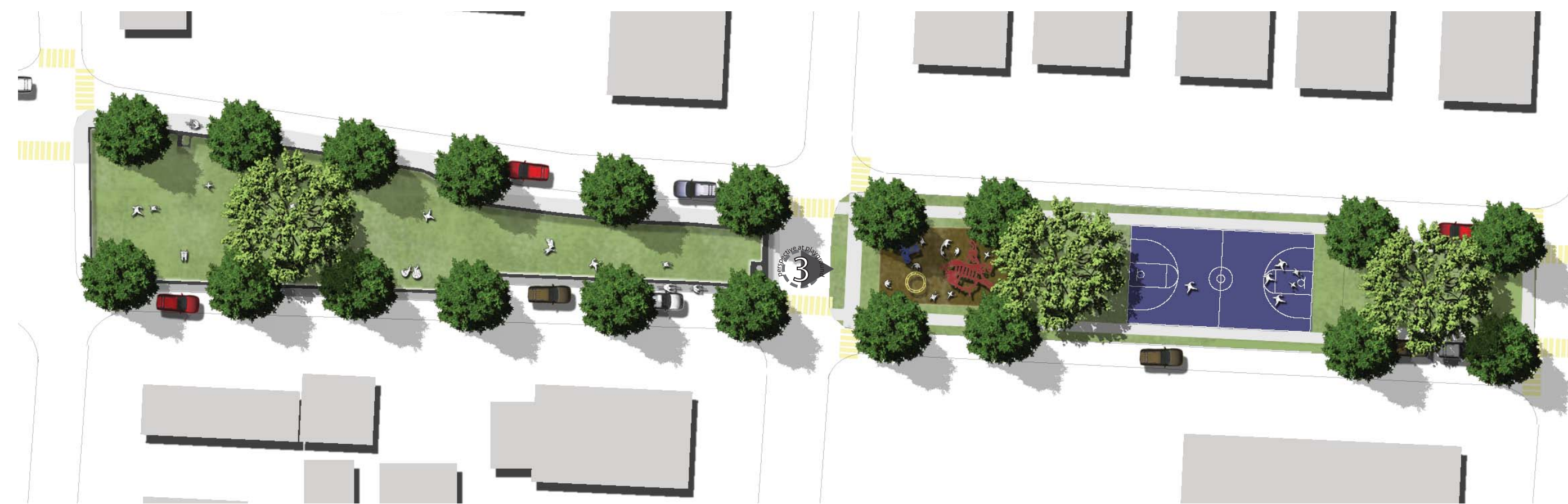

LAKE AVENUE PARK
Plan View

Lake Avenue Park is designed to serve the surrounding neighborhoods and adds an additional 12,500 square feet of green space. The design proposes reducing West Esplanade from Papworth Avenue to Lake Avenue from four lanes to two lanes, with the introduction of on-street parking. A basketball court, children's playground, and bark park greatly increases recreational opportunities and usability of valuable open space.

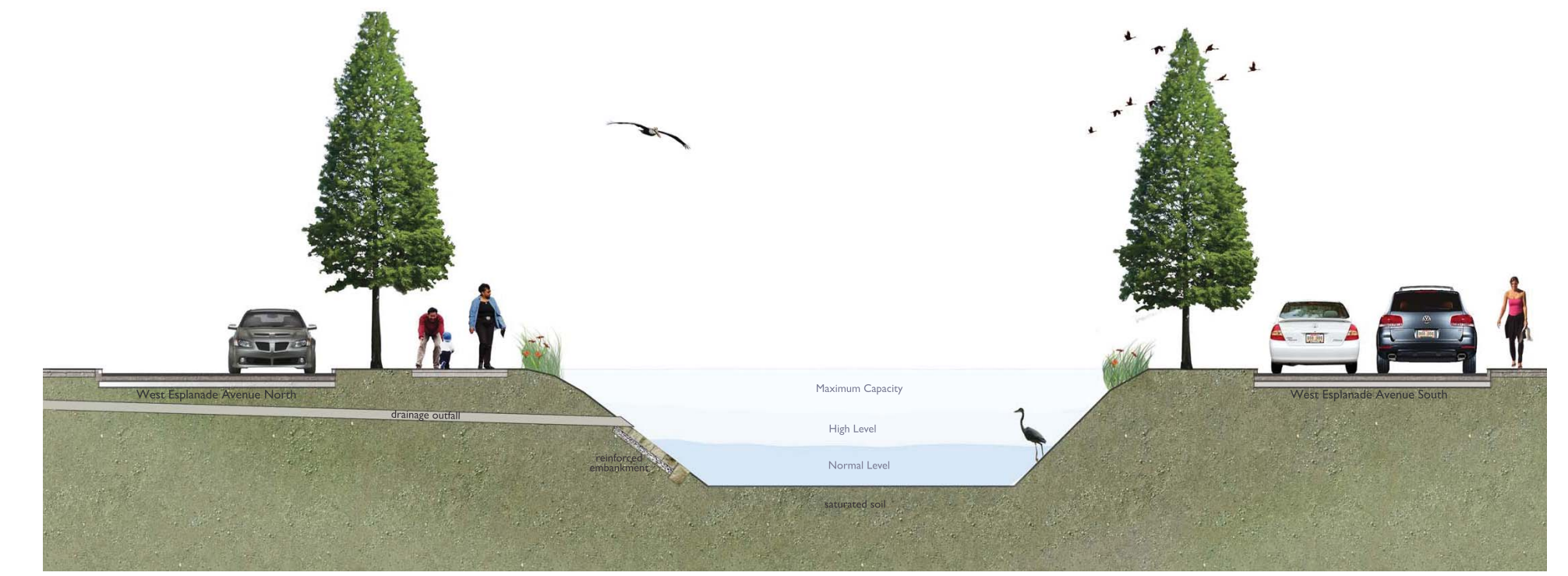

Section A

By simply cutting and removing portions of outfall pipe that extend into the canal, and hardening the bank to prevent scour or erosion, the visual appearance of the canal will greatly improve.

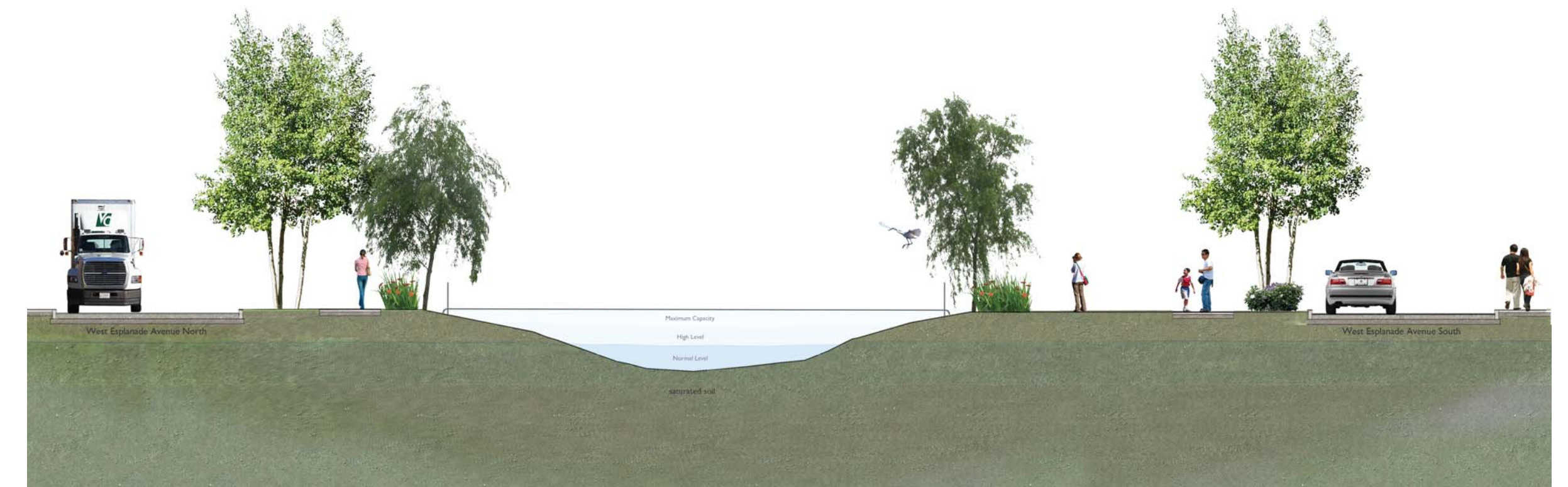

Section B

Providing areas of protected habitat for migratory and resident birds integrates visual screening of unsightly utility pipes in a way that improves the aesthetic without compromising flood control.



Section C

Safe pedestrian crossings are critical to the success of this project. Accommodating a continuous pedestrian promenade and programmed spaces, such as a bark park, will transform a space that physically divided the community into a space that connects people to each other and their environment.

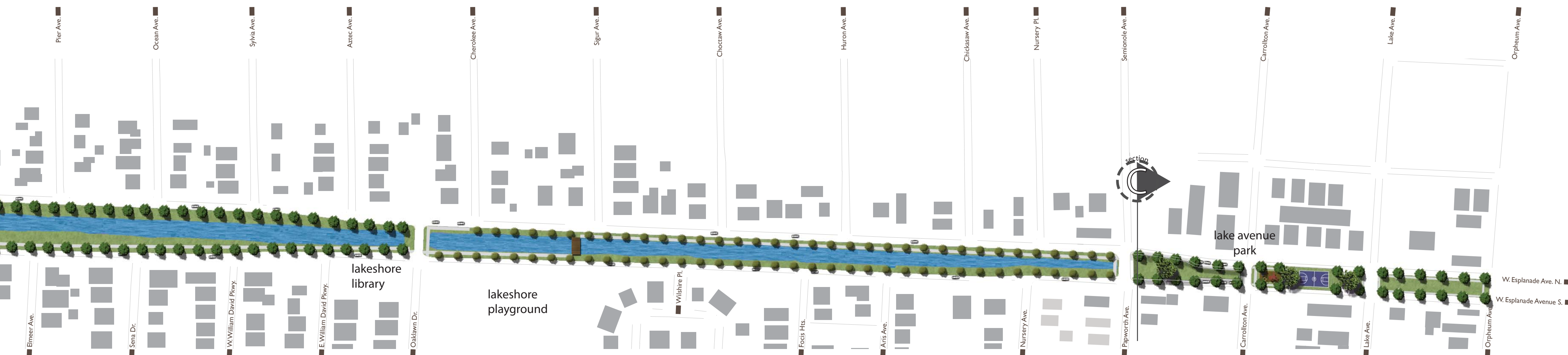

Estimate of Probable Costs:				
Making Connections: People. Places. Environment. Design Proposal				
Jefferson Drainage Canal Design Competition				
Jefferson Parish, Louisiana				25-Apr-11
Demolition and Site Work				
Item	Quantity	Unit	Unit Cost	Total
asphalt paving between Papworth and Lake	12120	sq.ft.	\$ 1.50	\$ 18,180.00
concrete curb between Papworth and Lake	1	allowance	\$ 3,800.00	\$ 3,800.00
sections of wood pilings	1	allowance	\$ 15,000.00	\$ 15,000.00
cut and remove 12" to 36" diameter pipe extension	114	each	\$ 250.00	\$ 28,500.00
fine grading and earthwork	1	allowance	\$120,000.00	\$ 120,000.00
Demolition and Site Work Sub-Total:				\$ 185,480.00
Overall Site Improvements:				
Item	Quantity	Unit	Unit Cost	Total
8' wide walking/bike paths (concrete-natural grey)	101680	sq.ft.	\$ 6.50	\$ 660,920.00
Bank hardening at outfall (grade beam, CMU, aggregate base)	114	each	\$ 492.00	\$ 56,088.00
new concrete curb between Papworth and Lake	1828	ln.ft.	\$ 4.50	\$ 8,226.00
pedestrian safety (signs, crosswalk striping, caution lights)	1	allowance	N.I.C.	N.I.C.
30 gallon trees	324	each	\$ 275.00	\$ 89,100.00
3 gallon shrub	3200	each	\$ 20.00	\$ 64,000.00
1 gallon ground cover/shrub	1074	each	\$ 4.00	\$ 4,296.00
Bermuda turf	7532	sq. yds	\$ 3.00	\$ 22,596.00
bed prep	1	allowance	\$ 8,000.00	\$ 8,000.00
Overall Site Improvements Sub-Total:				\$ 913,226.00
Canal Square				
Item	Quantity	Unit	Unit Cost	Total
concrete seatwalls	980	ln.ft.	\$ 120.00	\$ 117,600.00
steel decking support	2	allowance	\$ 68,000.00	\$ 136,000.00
wood decking	4260	sq.ft.	\$ 23.00	\$ 97,980.00
railing	176	ln.ft.	\$ 125.00	\$ 22,000.00
concrete paving	640	sq.ft.	\$ 6.50	\$ 4,160.00
lighting	1	allowance	\$ 15,000.00	\$ 15,000.00
3 gallon shrubs	125	each	\$ 20.00	\$ 2,500.00
Drainage	1	allowance	\$ 6,000.00	\$ 6,000.00
Irrigation	1	allowance	\$ 4,500.00	\$ 4,500.00
Canal Square Sub-Total:				\$ 405,740.00
Hesper Plaza				
Item	Quantity	Unit	Unit Cost	Total
pavilion	1	allowance	\$ 95,000.00	\$ 95,000.00
concrete plaza paving	9600	sq.ft.	\$ 6.50	\$ 62,400.00
brick banding	750	ln.ft.	\$ 8.50	\$ 6,375.00
site furnishings (benches, trash receptacle, bike racks)	1	allowance	\$ 22,000.00	\$ 22,000.00
palm trees - 10' clear trunk	6	each	\$ 2,300.00	\$ 13,800.00
3 gallon shrubs	320	each	\$ 20.00	\$ 6,400.00
drainage	1	allowance	\$ 6,000.00	\$ 6,000.00
irrigation	1	allowance	\$ 4,000.00	\$ 4,000.00
lighting	1	allowance	\$ 12,000.00	\$ 12,000.00

	Hesper Plaza Sub-Total:			\$ 227,975.00
Lake Avenue Park				
Item	Quantity	Unit	Unit Cost	Total
basketball court	1	each	\$ 60,000.00	\$ 60,000.00
play tower	1	each	\$ 52,000.00	\$ 52,000.00
supernova play equipment	1	each	\$ 18,000.00	\$ 18,000.00
coupe delux play equipment	1	each	\$ 12,500.00	\$ 12,500.00
bonded rubber mulch play surface	15000	sq.ft	\$ 6.50	\$ 97,500.00
8" wide concrete band	160	ln.ft.	\$ 5.50	\$ 880.00
5' vinyl coated black fencing	839	ln.ft.	\$ 25.00	\$ 20,975.00
lighting	1	allowance	\$ 20,000.00	\$ 20,000.00
drinking fountain	2	each	\$ 2,500.00	\$ 5,000.00
site furnishing (benches, trash receptacle, bike racks)	1	allowance	\$ 18,000.00	\$ 18,000.00
3 gallon shrubs	125	each	\$ 20.00	\$ 2,500.00
turf infill	1	allowance	\$ 1,500.00	\$ 1,500.00
drainage	1	allowance	\$ 4,000.00	\$ 4,000.00
irrigation	1	allowance	\$ 2,500.00	\$ 2,500.00
	Playground and Bark Park:			\$ 315,355.00
			Project Sub-Total:	\$ 2,047,776.00
			5% Mobilization:	\$ 102,388.80
			15% Overhead and Profit:	\$ 307,166.40
			Project Total:	\$ 2,457,331.20
The annual maintenance budget for Making Connections is approximately \$76,000. Recommended maintenance activities would include: mowing, seasonal pruning, daily litter removal, and monitoring of irrigation and lighting systems.				

Financial Strategy

The estimated cost of the Making Connections design proposal is two and one half million dollars. This cost does not include engineering or permitting fees. The direct benefactors of the beautification project will be residents of Jefferson Parish and the parish should be the primary funding source. Federal funding for the sidewalks and pedestrian and bicycle safety measures may be available through The Federal-Aid Highway Program Surface Transportation Program and/or Surface Transportation Program. State funding may be available, for up to \$100,000 for the bridges at Canal Square through Recreational Trails Program for Louisiana. The Jefferson Parish budget includes Capital Outlay Funds, Culture and Recreation, and Urban Redevelopment dollars that could be tapped into as logical sources of project funding.

Friends of Jefferson Parish the Beautiful matching grants may be available as well as sources such as private and nonprofit group. KaBOOM is an organization committed to building playgrounds and Moon's Tree Farm, Inc. is a grower with a tree donation program for public and municipal projects. Once the initial public investment has been made, and construction activities are underway, it is reasonable to assume that the private sector will begin to develop commercial and residential properties within the area.



